

PHB Receptacle + PHB Header

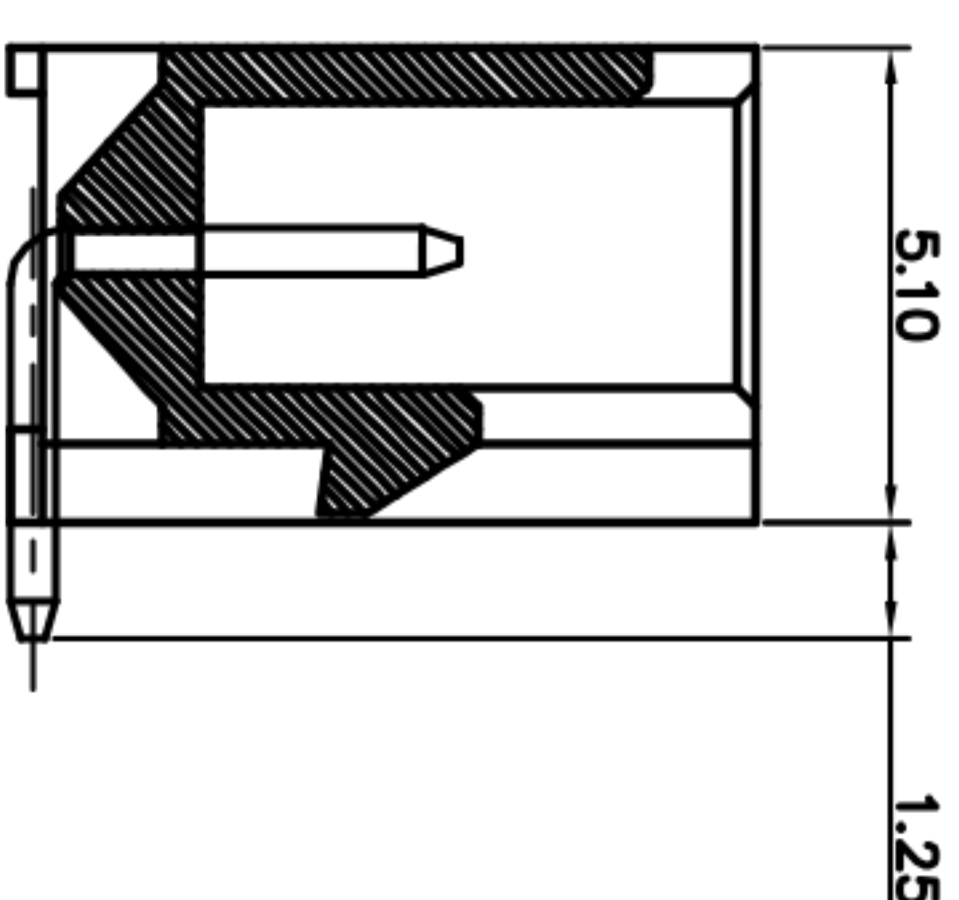

- 1 Current rating: 2A AC\DC (AWG #22-24)
- 2 Voltage rating: 125V AC\DC
- 3 Temperature range: -25°C to 85°C
- 4 Contact resistance: Initial value/30mΩ max  
Electrical properties
- 5 Insulation resistance: 1000MΩ min
- 6 Withstanding voltage: 1000V AC/ minute
- 7 Applicable wire: AWG #22 to #24  
Environmental controls
- 1 Banned contains SS - 00259 are restricted substances.
- 2 The corresponding issued by SGS or ITS icp-des data,  
Not the material in a list, and validity.

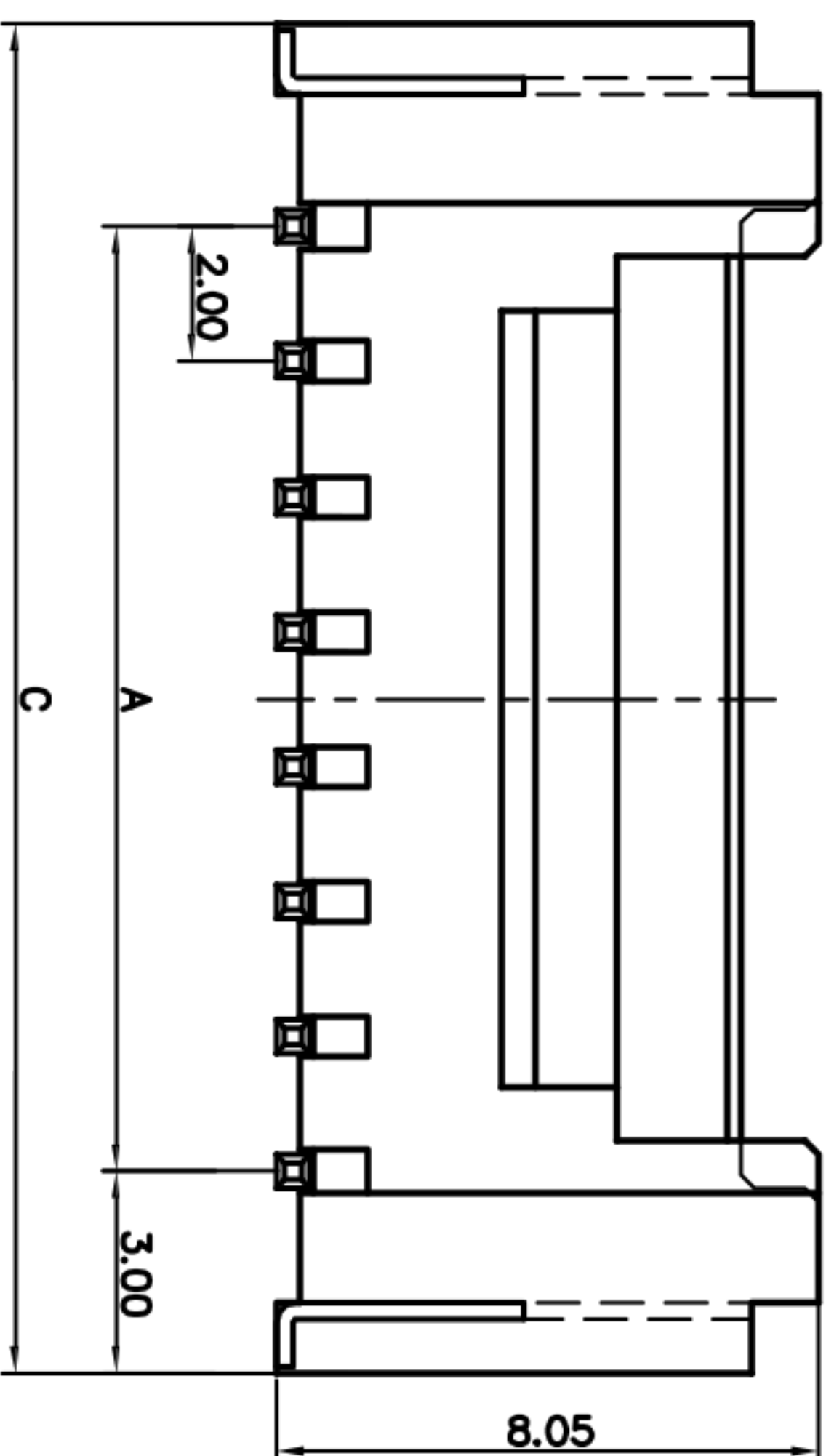
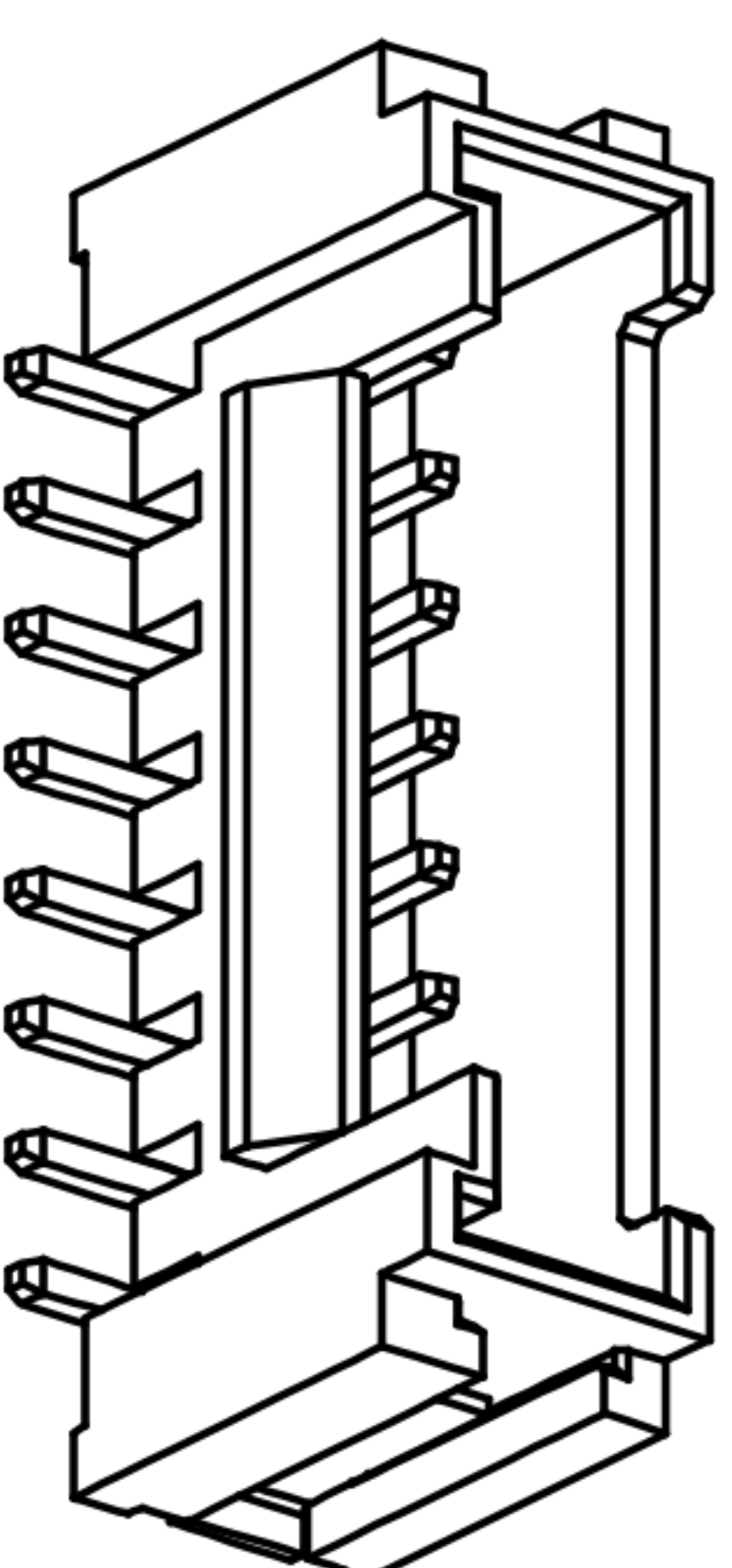
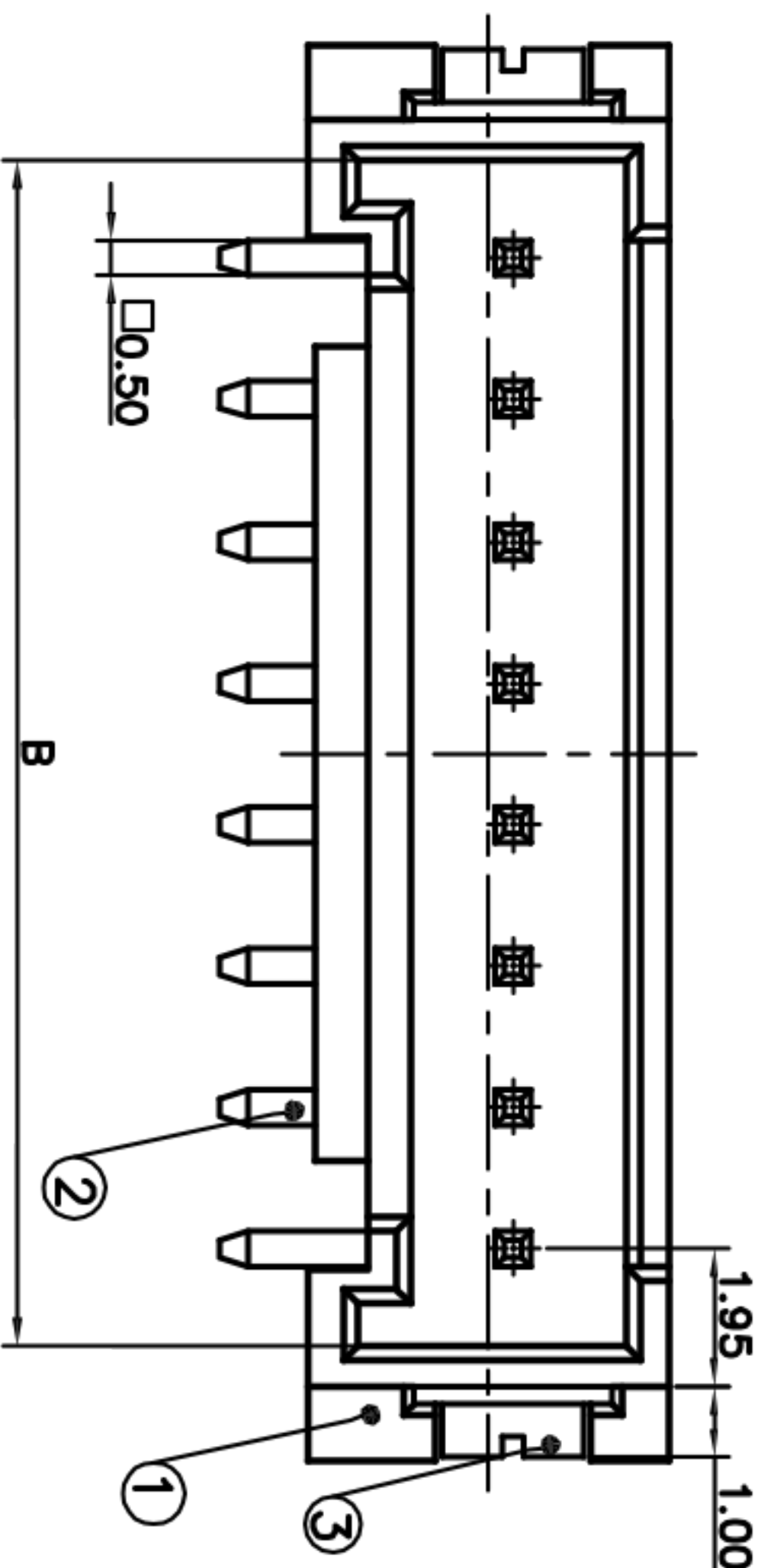
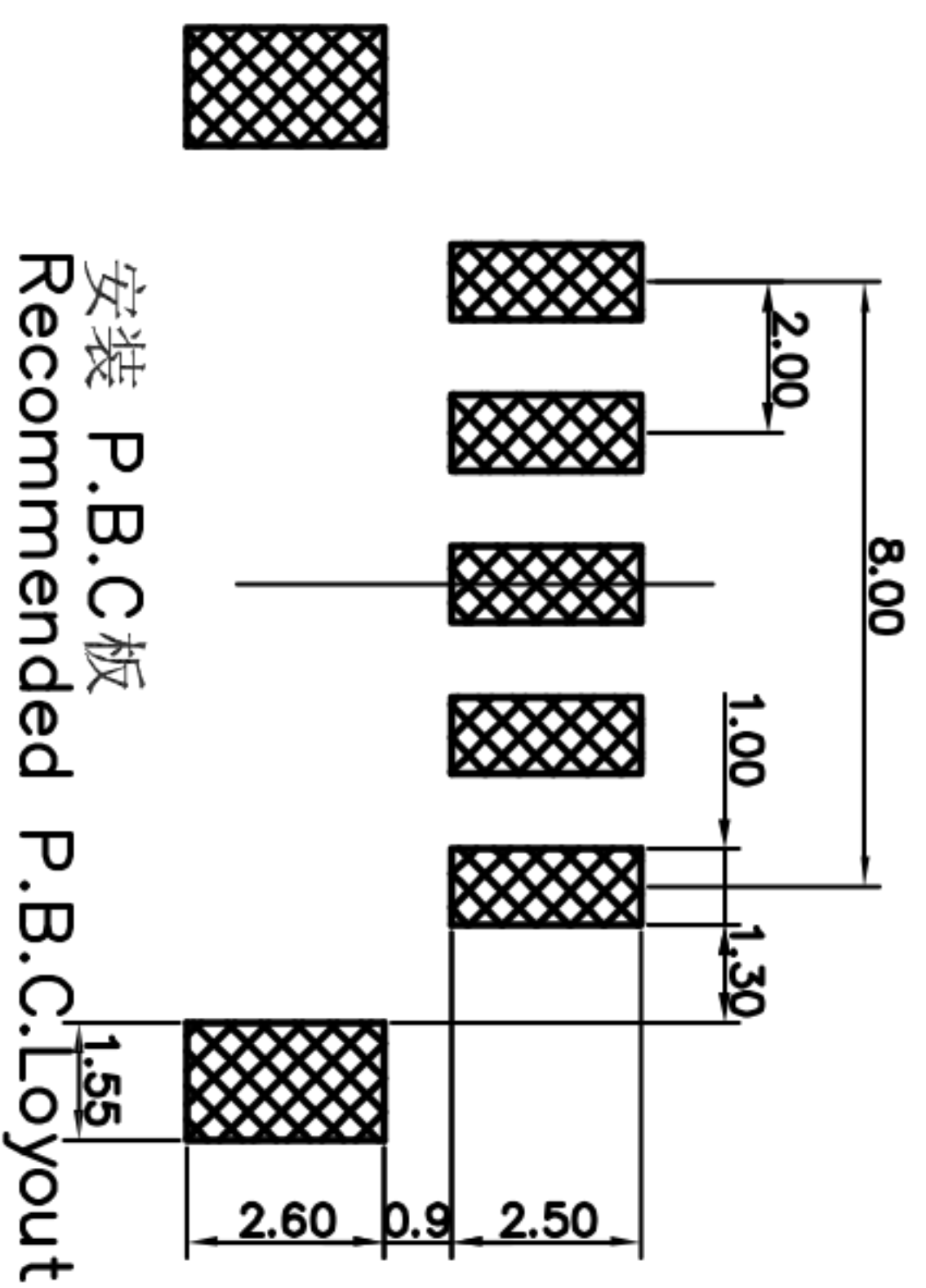

PIN	A	B	C
2	2.0	4.75	8.0
3	4.0	6.75	10.0
4	6.0	8.75	12.0
5	8.0	10.75	14.0
6	10.0	12.75	16.0
7	12.0	14.75	18.0
8	14.0	16.75	20.0
9	16.0	18.75	22.0
10	18.0	20.75	24.0
11	20.0	22.75	26.0
12	22.0	24.75	28.0
13	24.0	26.75	30.0
14	26.0	28.75	32.0
15	28.0	30.75	34.0
16	30.0	32.75	36.0

ECN NO.	REV.	DATE.	DESCRIPTION.	CHANGE.	CHECK.	APPRO.
	A		NEW			

APPROVALS		DATE	TITLE:			
DRAWN	ZHIWEI.CHEN	2015.07.07	PART NO. GP01-2002WVS-NP			
CHECKED			UNIT: mm SCALE: 1:1			
APPROVALS			PROJ:			
TOLERANCES ARE		ANGLE	DRAWING NO.		SHEET 1 OF 1	
30 <sup>±0.30</sup>	±0.30	±2°				
10 <sup>±0.20</sup>	±0.20					
5 <sup>±0.15</sup>	±0.15					
~ 5	±0.10					

**深圳市联丰电子有限公司**  
SHENZHEN LINFENG ELECTRONIC CO.,LTD