

MATING HEIGHT  
SCALE:1:25:1

3D VIEW

NOTES:

HOUSING: HIGH TEMPERATURE HOUSING UL94V-0  
 WITHSTANDS IR AND VPR SOLDERING METHODS.  
 CONTACTS: PHOSPHOR BRONZE.  
 PLATING: GOLD PLATED.  
 ELECTRICAL CHARACTERISTICS:  
 CURRENT RATING:0.3 AMP.  
 INSULATOR RESISTANCE:1000MΩ MIN. AT DC 250V.  
 CONTACT RESISTANCE:90MΩ MAX. AT DC 100MA.  
 OPERATING TEMPERATURE:-55°C ~+85°C .

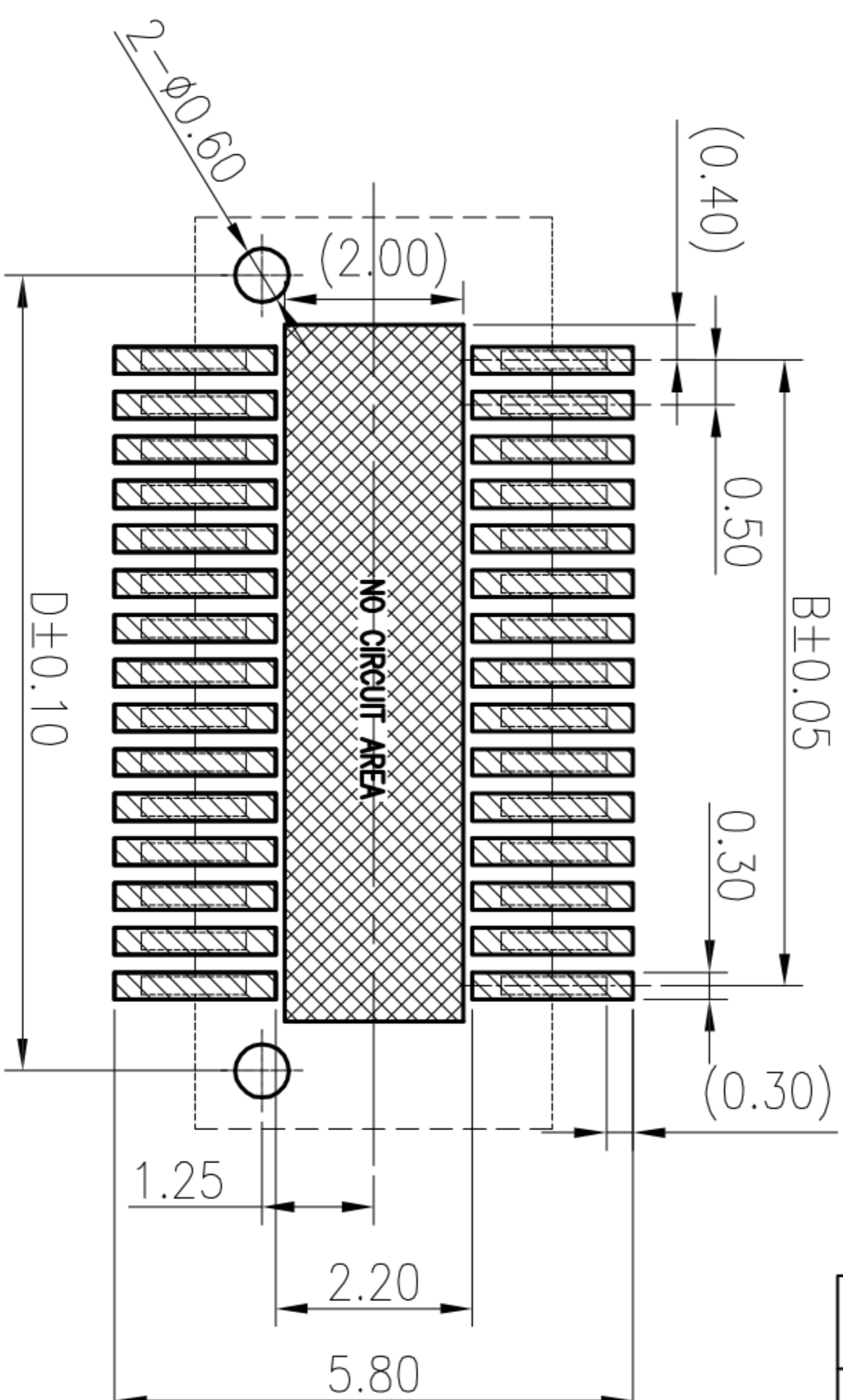
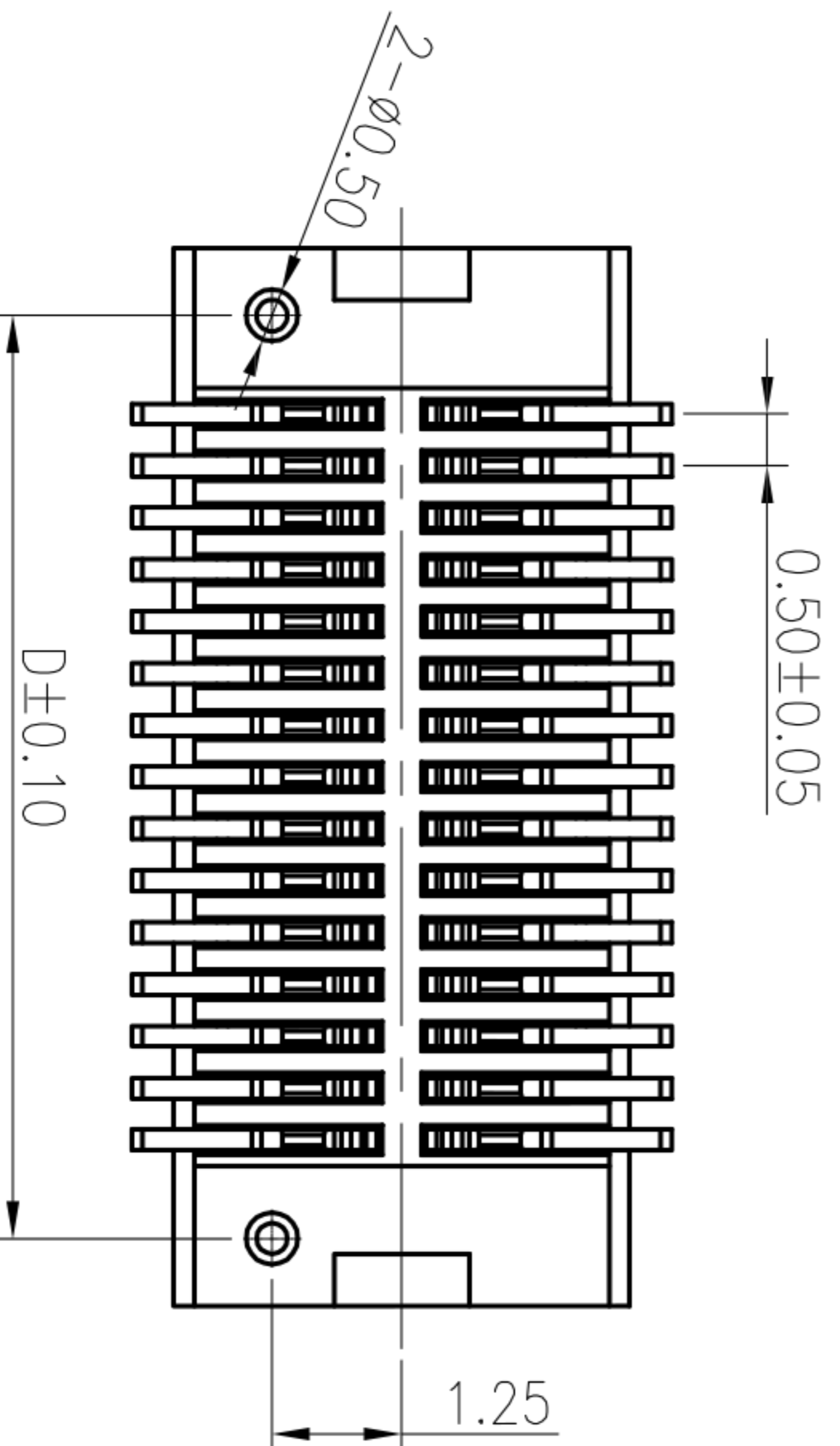
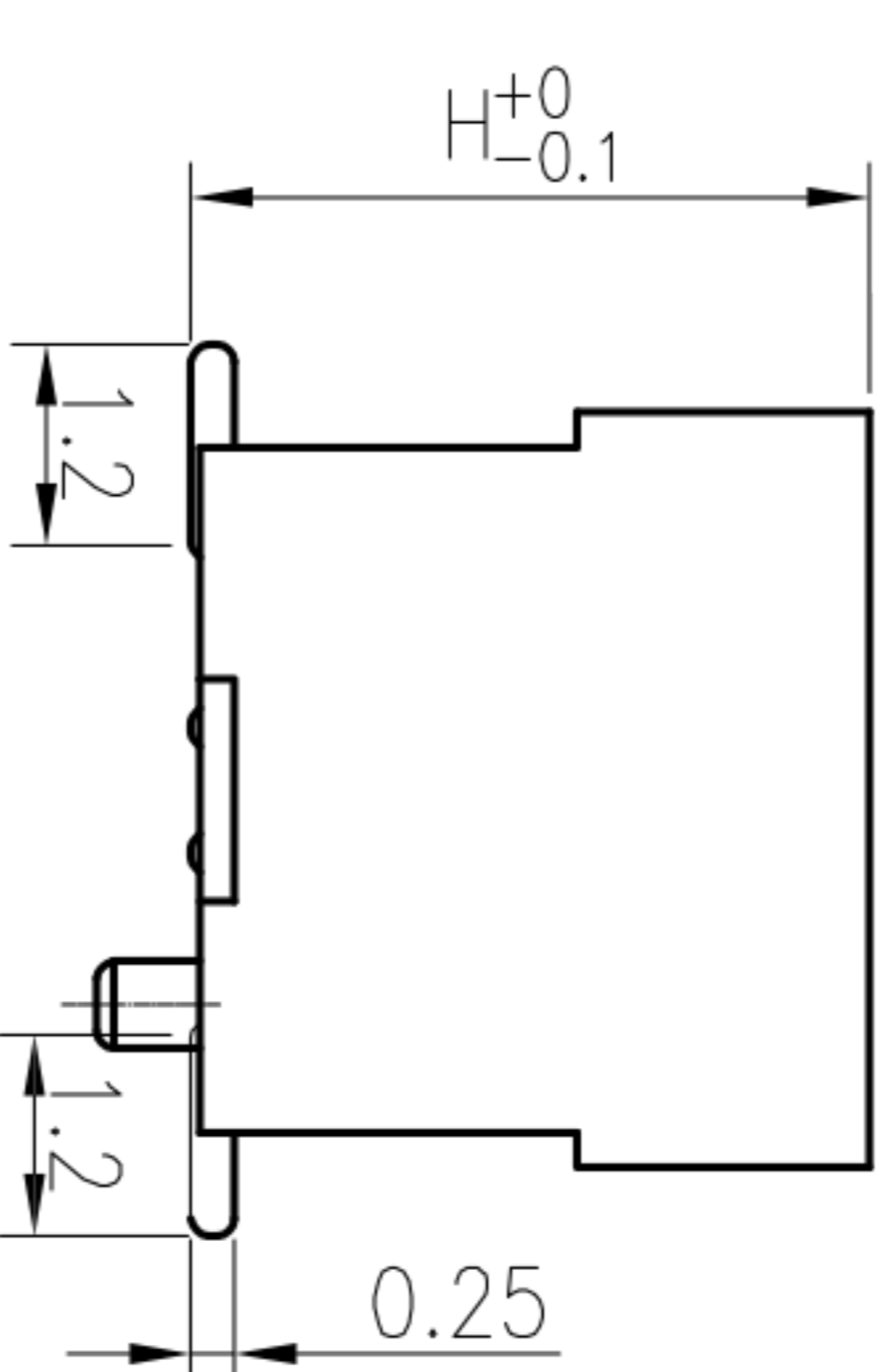
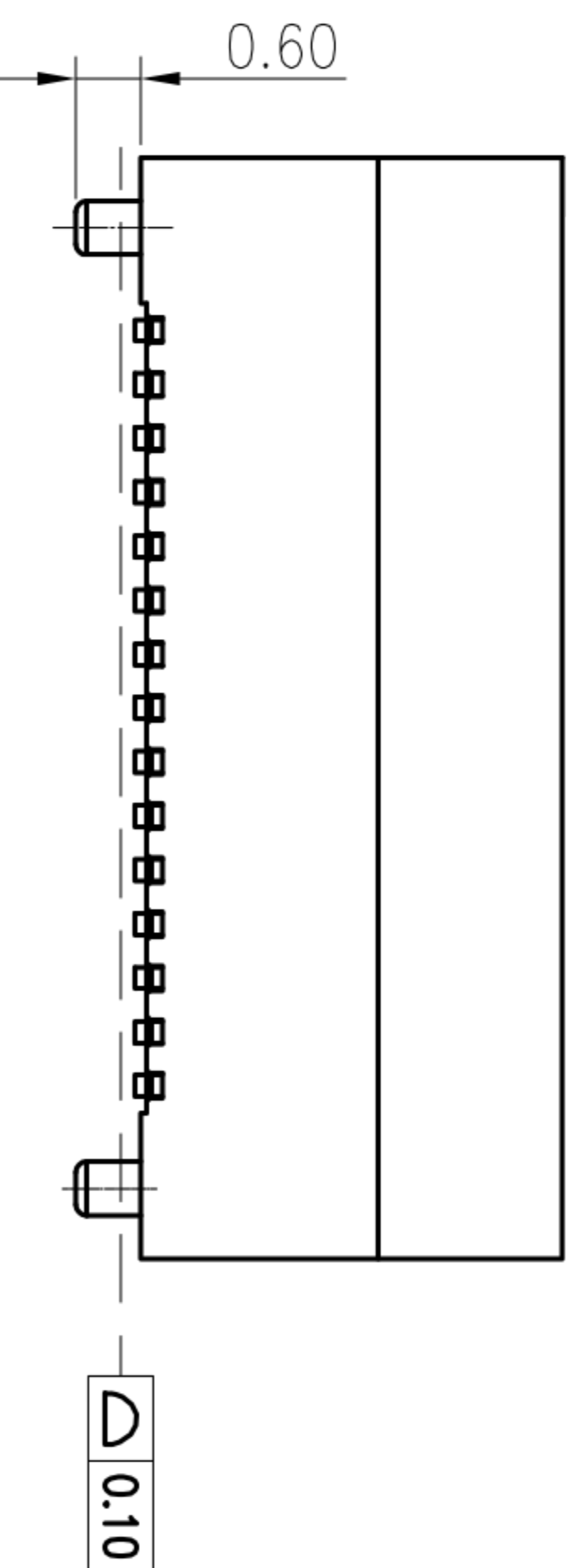

| MATING HEIGHT | PLUG (H) | SOCKET (H) | NO. of contac ts | Dimensions |       |       |       | NO. of contac ts | Dimensions |       |       |       |
|---------------|----------|------------|------------------|------------|-------|-------|-------|------------------|------------|-------|-------|-------|
|               |          |            |                  | A          | B     | C     | D     |                  | A          | B     | C     | D     |
| 3.0           | 0.8      | 2.2        | 4                | 3.70       | 0.50  | 1.56  | 2.40  | 54               | 16.20      | 13.00 | 14.06 | 14.90 |
| 3.5           | 1.3      | 2.2        | 6                | 4.20       | 1.00  | 2.06  | 2.90  | 56               | 16.70      | 13.50 | 14.56 | 15.40 |
| 4.0           | 1.0      | 3.0        | 8                | 4.70       | 1.50  | 2.56  | 3.40  | 58               | 17.20      | 14.00 | 15.06 | 15.90 |
| 4.5           | 1.0      | 3.5        | 10               | 5.20       | 2.00  | 3.06  | 3.90  | 60               | 17.70      | 14.50 | 15.56 | 16.40 |
| 5.0           | 1.0      | 4.0        | 12               | 5.70       | 2.50  | 3.56  | 4.40  | 62               | 18.20      | 15.00 | 16.06 | 16.90 |
| 5.5           | 2.0      | 4.5        | 14               | 6.20       | 3.00  | 4.06  | 4.90  | 64               | 18.70      | 15.50 | 16.56 | 17.40 |
| 6.0           | 2.0      | 4.0        | 16               | 6.70       | 3.50  | 4.56  | 5.40  | 66               | 19.20      | 16.00 | 17.06 | 17.90 |
| 6.5           | 2.0      | 4.5        | 18               | 7.20       | 4.00  | 5.06  | 5.90  | 68               | 19.70      | 16.50 | 17.56 | 18.40 |
|               |          |            | 20               | 7.70       | 4.50  | 5.56  | 6.40  | 70               | 20.20      | 17.00 | 18.06 | 18.90 |
|               |          |            | 22               | 8.20       | 5.00  | 6.06  | 6.90  | 72               | 20.70      | 17.50 | 18.56 | 19.40 |
|               |          |            | 24               | 8.70       | 5.50  | 6.56  | 7.40  | 74               | 21.20      | 18.00 | 19.06 | 19.90 |
|               |          |            | 26               | 9.20       | 6.00  | 7.06  | 7.90  | 76               | 21.70      | 18.50 | 19.56 | 20.40 |
|               |          |            | 28               | 9.70       | 6.50  | 7.56  | 8.40  | 78               | 22.20      | 19.00 | 20.06 | 20.90 |
|               |          |            | 30               | 10.20      | 7.00  | 8.06  | 8.90  | 80               | 22.70      | 19.50 | 20.56 | 21.40 |
|               |          |            | 32               | 10.70      | 7.50  | 8.56  | 9.40  | 82               | 23.20      | 20.00 | 21.06 | 21.90 |
|               |          |            | 34               | 11.20      | 8.00  | 9.06  | 9.90  | 84               | 23.70      | 20.50 | 21.56 | 22.40 |
|               |          |            | 36               | 11.70      | 8.50  | 9.56  | 10.40 | 86               | 24.20      | 21.00 | 22.06 | 22.90 |
|               |          |            | 38               | 12.20      | 9.00  | 10.06 | 10.90 | 88               | 24.70      | 21.50 | 22.56 | 23.40 |
|               |          |            | 40               | 12.70      | 9.50  | 10.56 | 11.40 | 90               | 25.20      | 22.00 | 23.06 | 23.90 |
|               |          |            | 42               | 13.20      | 10.00 | 11.06 | 11.90 | 92               | 25.70      | 22.50 | 23.56 | 24.40 |
|               |          |            | 44               | 13.70      | 10.50 | 11.56 | 12.40 | 94               | 26.20      | 23.00 | 24.06 | 24.90 |
|               |          |            | 46               | 14.20      | 11.00 | 12.06 | 12.90 | 96               | 26.70      | 23.50 | 24.56 | 25.40 |
|               |          |            | 48               | 14.70      | 11.50 | 12.56 | 13.40 | 98               | 27.20      | 24.00 | 25.06 | 25.90 |
|               |          |            | 50               | 15.20      | 12.00 | 13.06 | 13.90 | 100              | 27.70      | 24.50 | 25.56 | 26.40 |

|           |             |            |  |  |             |                   |
|-----------|-------------|------------|--|--|-------------|-------------------|
| APPROVALS |             | DATE       | <b>深圳市联丰电子有限公司</b><br>SHENZHEN LIANFENG ELECTRONIC CO.,LTD |  |             |                   |
| DRAWN     | ZHIWEI.CHEN | 2015.07.07 | TITLE:   | 0.5MM BTB 双槽立式母座H3.0~6.5                             | PART NO.    | GP02-4XX-CXXS-B0R |
| CHECKED   |             |            | ANGLE  | ±2°  | UNIT: mm    | SCALE: 1:1        |
| APPROVALS |             |            | TOLERANCES ARE   | 30~以上 ±0.30<br>10~30 ±0.20<br>5~10 ±0.15<br>~5 ±0.10 | DRAWING NO. | PROJ:             |
| ECN NO.   | REV.        | DATE.      | NEW  | CHANGE.  | CHECK.      | APPRO.            |
|           | A           |            | DESCRIPTION.   |  |             |                   |
|           |             |            |  |  |             | SHEET 1 OF 1      |