

NOTES:

HOUSING: HIGH TEMPERATURE HOUSING UL94V-0
 WITHSTANDS IR AND VPR SOLDERING METHODS.
 CONTACTS: PHOSPHOR BRONZE.
 PLATING: GOLD PLATED.
 ELECTRICAL CHARACTERISTICS:
 CURRENT RATING:0.3 AMP.
 INSULATOR RESISTANCE:1000MΩ MIN. AT DC 250V.
 CONTACT RESISTANCE:90MΩ MAX. AT DC 100MA.
 OPERATING TEMPERATURE:-55°C ~+85°C .

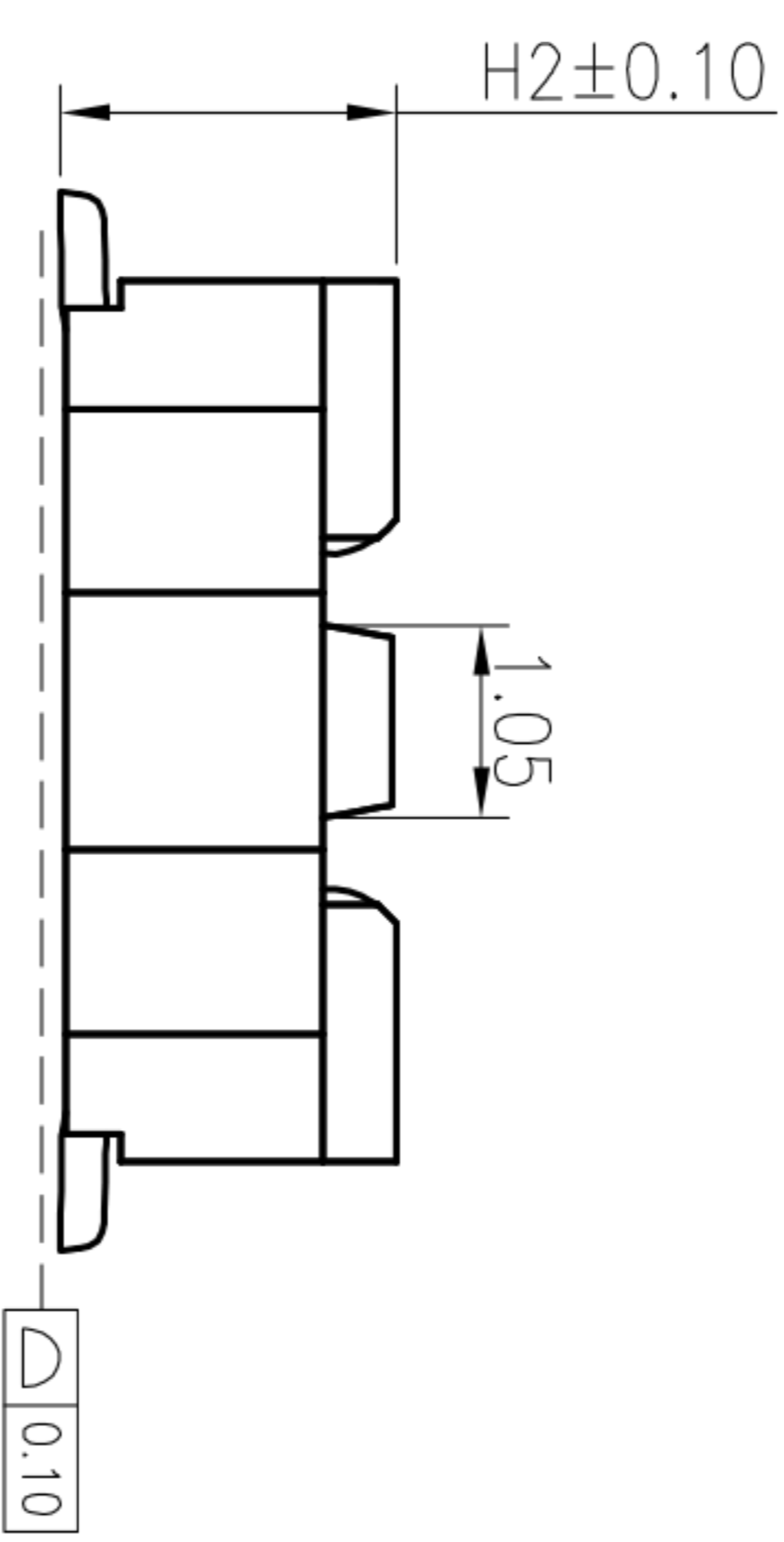
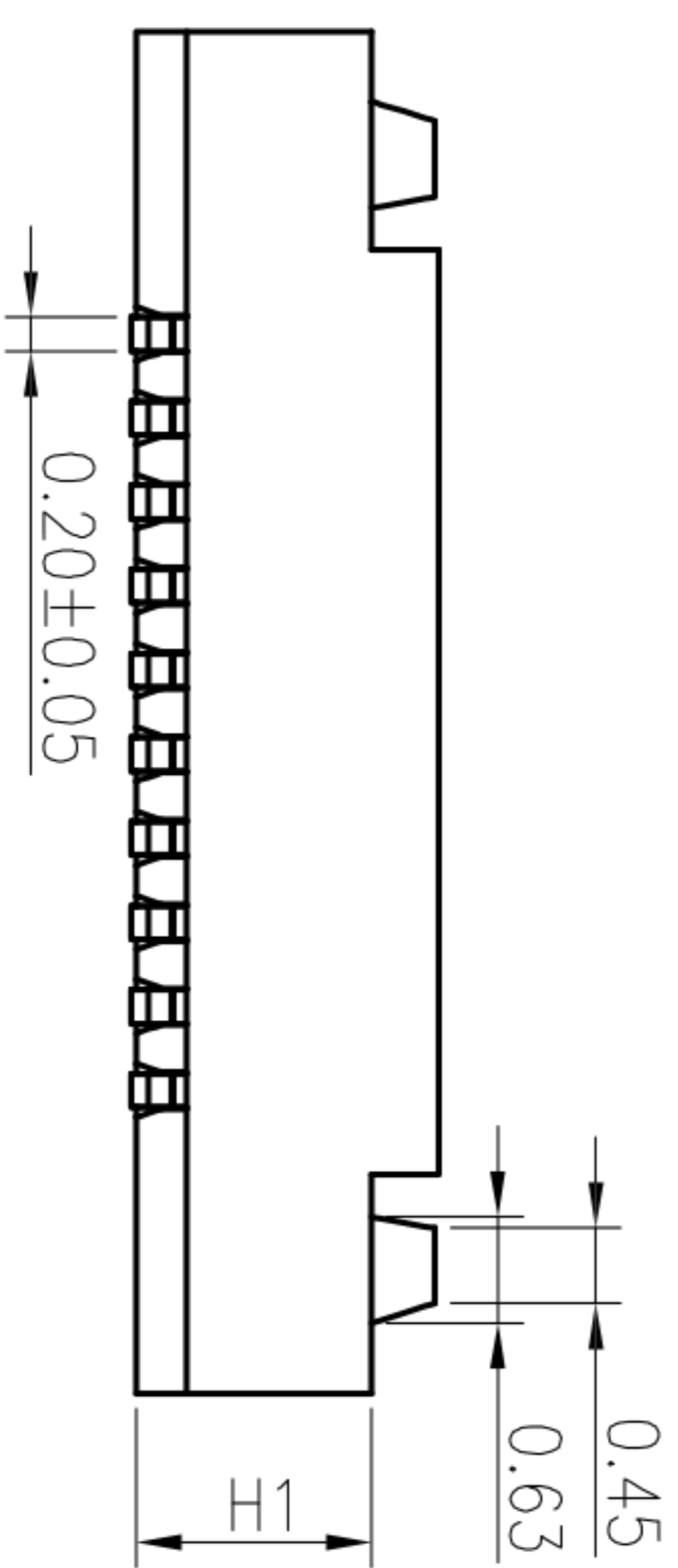

RECOMMENDED PCB PATTERN DIM.
 TOLERANCE : ±0.05

| MATING HEIGHT | PLUG (H.) | SOCKET (H.) | H1 | H2 |
|---------------|-----------|-------------|-----|-----|
| 1.5 | 1.5 | 1.5 | 0.9 | 1.4 |
| 2.0 | 2.0 | 2.0 | 1.4 | 1.9 |
| 2.5 | 1.5 | 2.5 | 1.9 | 2.4 |

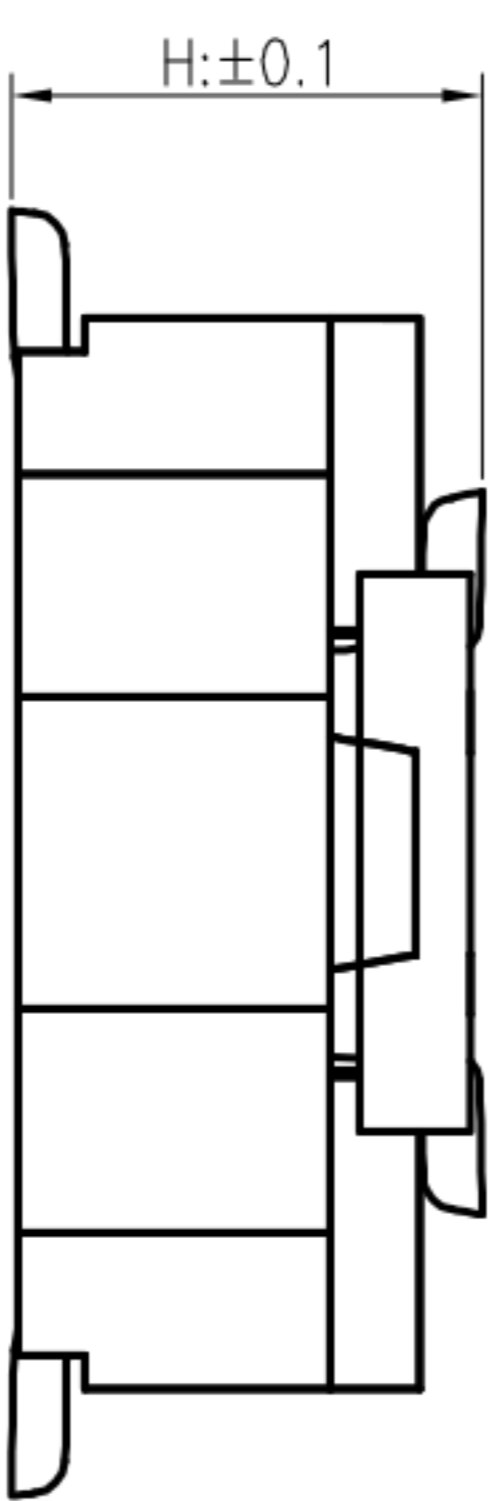
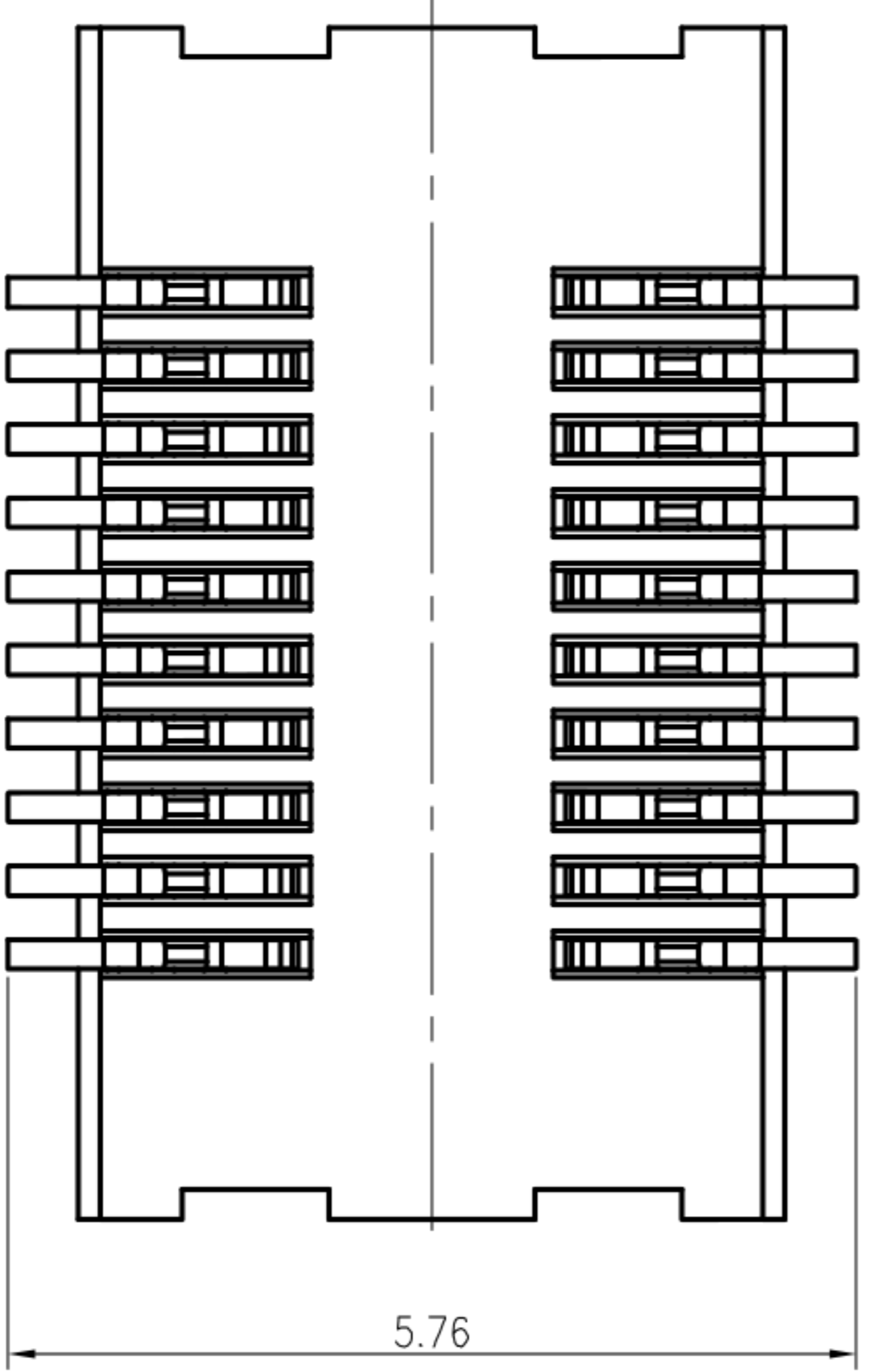

MATING HEIGHT

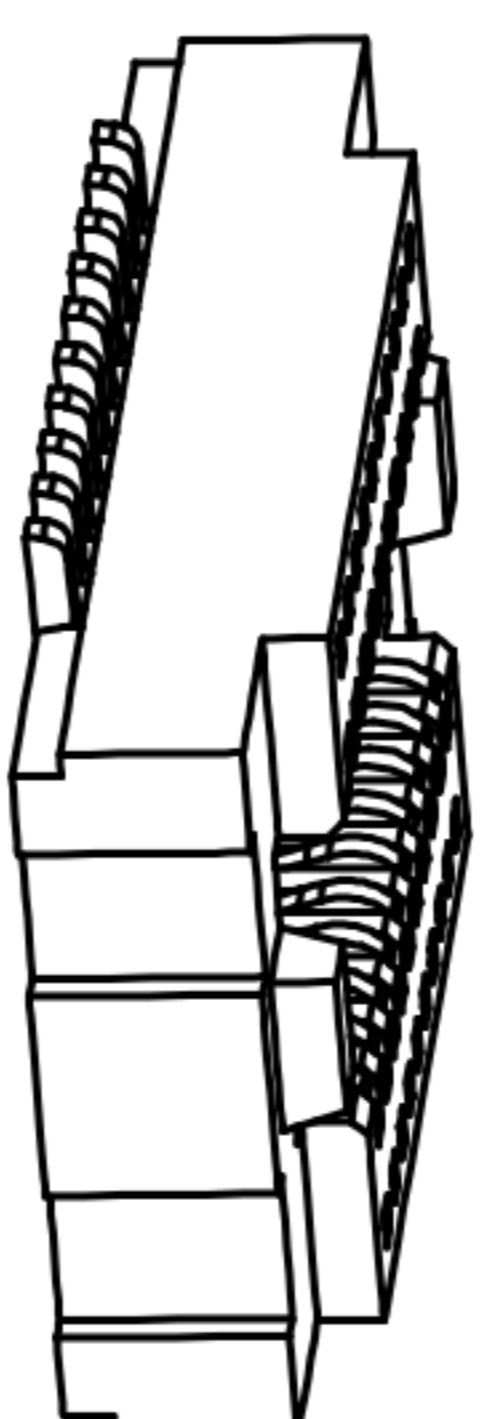

3D VIEW

| NO. of contacts | Dimensions | | | |
|-----------------|------------|-------|-------|-------|
| | A. | B. | C. | D. |
| 10 | 5.60 | 2.00 | 3.50 | 3.90 |
| 12 | 6.10 | 2.50 | 4.00 | 4.40 |
| 16 | 7.10 | 3.50 | 5.00 | 5.40 |
| 18 | 7.60 | 4.00 | 5.50 | 5.90 |
| 20 | 8.10 | 4.50 | 6.00 | 6.40 |
| 14 | 6.60 | 3.00 | 4.50 | 4.90 |
| 16 | 7.10 | 3.50 | 5.00 | 5.40 |
| 18 | 7.60 | 4.00 | 5.50 | 5.90 |
| 20 | 8.10 | 4.50 | 6.00 | 6.40 |
| 22 | 8.60 | 5.00 | 6.50 | 6.90 |
| 24 | 9.10 | 5.50 | 7.00 | 7.40 |
| 26 | 9.60 | 6.00 | 7.50 | 7.90 |
| 28 | 10.10 | 6.50 | 8.00 | 8.40 |
| 30 | 10.60 | 7.00 | 8.50 | 8.90 |
| 32 | 11.10 | 7.50 | 9.00 | 9.40 |
| 36 | 12.10 | 8.50 | 10.00 | 10.40 |
| 40 | 13.10 | 9.50 | 11.00 | 11.40 |
| 50 | 15.60 | 12.00 | 13.50 | 13.90 |
| 100 | 28.10 | 24.50 | 26.00 | 26.40 |

| | | | | | | |
|---------|------|-------|--------------|---------|--------|--------|
| ECN NO. | REV. | DATE. | DESCRIPTION. | CHANGE. | CHECK. | APPRO. |
| | A | | NEW | | | |

| APPROVALS | | DATE | TITLE: | |
|----------------|-------------|------------|--------------------------|--------------|
| DRAWN | ZHIWEI.CHEN | 2015.07.07 | 0.5MM BTB 单槽立式母座H1.5~2.5 | |
| CHECKED | | | GP02-5XX-GXXS-WOR | |
| APPROVALS | | | | |
| TOLERANCES ARE | | | ANGLE | UNIT: mm |
| 30~以上 | ±0.30 | | ±2° | SCALE: 1:1 |
| 10~30 | ±0.20 | | | PROJ: |
| 5~10 | ±0.15 | | | |
| ~ 5 | ±0.10 | | | SHEET 1 OF 1 |



深圳市联丰电子有限公司
 SHENZHEN LIANFENG ELECTRONIC CO.,LTD